

HIGH PRESSURE

EXTRA DISTANCE	EXTRA DISTANCE	FULL INOX	EXTRA DISTANCE
M12 (P12)	M12 (P12)	M12 (P12)	M14 (P20)
1.5 (2.5)	1.5 (2.5)	1.5	3

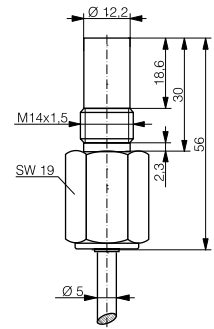
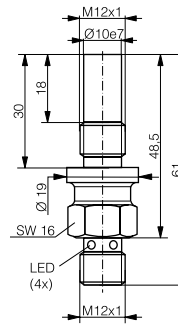
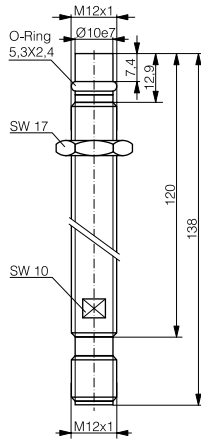
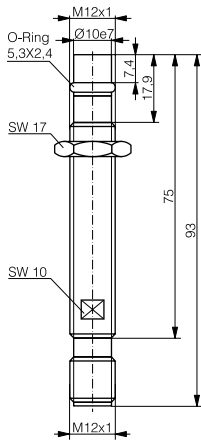

* IO-Link	* IO-Link	IO-Link	* IO-Link
Ceramic ZrO ₂	Ceramic ZrO ₂	Stainless steel V4A / AISI 316L	Ceramic ZrO ₂
500 bar	500 bar	500 bar	500 bar
1000 bar	1000 bar	800 bar	1000 bar
Stainless steel V2A	Stainless steel V2A	Stainless steel V4A / AISI 316L	Stainless steel V4A / AISI 316L
Connector S12	Connector S12	Connector S12	PUR cable
IP 68	IP 68	IP 68 / IP 69K	IP 68
Embeddable	Embeddable	Embeddable	Embeddable
600 Hz	600 Hz	850 Hz	500 Hz
10 ... 30 VDC	10 ... 30 VDC	10 ... 30 VDC	10 ... 30 VDC
-25 ... +100°C / -13 ... +212°F	-25 ... +100°C / -13 ... +212°F	-25 ... +85°C / -13 ... +185°F	-25 ... +100°C / -13 ... +212°F
≤ 200 mA	≤ 200 mA	≤ 200 mA	≤ 200 mA
DW-AS-503-P12-635	DW-AS-503-P12-622	DW-LS-703-P12G	DW-AD-503-P20
DW-AS-501-P12-635	DW-AS-501-P12-622		DW-AD-501-P20
PNP NC, NPN NC, 2.5 mm operating distance	PNP NC, NPN NC, 2.5 mm operating distance	PUR cable, pigtail	PNP NC, NPN NC

Inductive

Photoelectric

Safety

RFID

Connectivity

Accessories

Glossary

Index

HIGH PRESSURE

EXTRA DISTANCE	EXTRA DISTANCE	FULL INOX	EXTRA DISTANCE
M12 (P12)	M12 (P12)	M12 (P12)	M14 (P20)
1.5 (2.5)	1.5 (2.5)	1.5	3

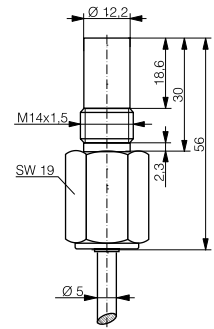
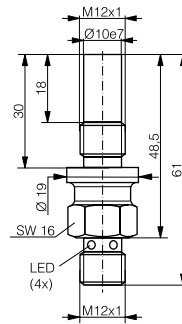
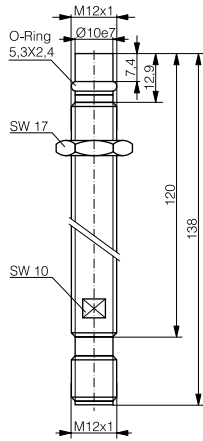
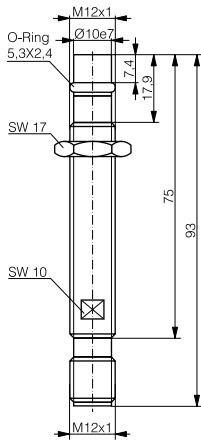

* IO-Link	* IO-Link	IO-Link	* IO-Link
Ceramic ZrO ₂	Ceramic ZrO ₂	Stainless steel V4A / AISI 316L	Ceramic ZrO ₂
500 bar	500 bar	500 bar	500 bar
1000 bar	1000 bar	800 bar	1000 bar
Stainless steel V2A	Stainless steel V2A	Stainless steel V4A / AISI 316L	Stainless steel V4A / AISI 316L
Connector S12	Connector S12	Connector S12	PUR cable
IP 68	IP 68	IP 68 / IP 69K	IP 68
Embeddable	Embeddable	Embeddable	Embeddable
600 Hz	600 Hz	850 Hz	500 Hz
10 ... 30 VDC	10 ... 30 VDC	10 ... 30 VDC	10 ... 30 VDC
-25 ... +100°C / -13 ... +212°F	-25 ... +100°C / -13 ... +212°F	-25 ... +85°C / -13 ... +185°F	-25 ... +100°C / -13 ... +212°F
≤ 200 mA	≤ 200 mA	≤ 200 mA	≤ 200 mA
DW-AS-503-P12-635	DW-AS-503-P12-622	DW-LS-703-P12G	DW-AD-503-P20
DW-AS-501-P12-635	DW-AS-501-P12-622		DW-AD-501-P20
PNP NC, NPN NC, 2.5 mm operating distance	PNP NC, NPN NC, 2.5 mm operating distance	PUR cable, pigtail	PNP NC, NPN NC

Inductive

Photoelectric

Safety

RFID

Connectivity

Accessories

Glossary

Index