

# WASHDOWN

INDUCTIVE

FAMILY	FULL INOX	FULL INOX	FULL INOX
HOUSING SIZE	M12	M18	M18
OPERATING DISTANCE MM	10	10	10

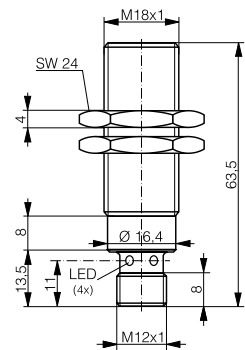
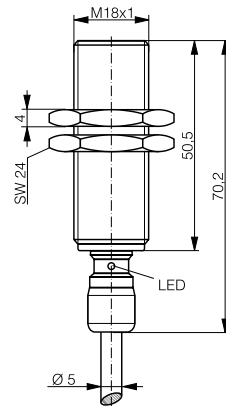
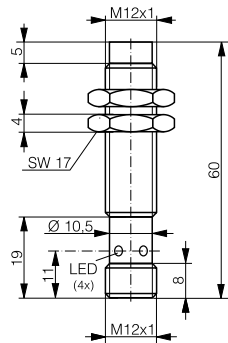

DATA	IO-Link	IO-Link	IO-Link
Operating pressure	80 bar	60 bar	60 bar
Housing material	Stainless steel V4A/AISI 316L	Stainless steel V4A/AISI 316L	Stainless steel V4A/AISI 316L
Connection	Connector S12	TPE-S cable	Connector S12
Degree of protection	IP 68 / IP 69K	IP 68 / IP 69K	IP 68 / IP 69K
Mounting	Non-embeddable	Embeddable	Embeddable
Max. switching frequency	400 Hz	300 Hz	300 Hz
Supply voltage range	10 ... 30 VDC	10 ... 30 VDC	10 ... 30 VDC
Ambient temperature range	-25 ... +85°C / -13 ... +185°F	-25 ... +85°C / -13 ... +185°F	-25 ... +85°C / -13 ... +185°F
Output current	≤ 200 mA	≤ 200 mA	≤ 200 mA
PNP NO	<b>DW-LS-713-M12</b>	<b>DW-LD-703-M18</b>	<b>DW-LS-703-M18-002</b>
Other types available	NPN NO, PNP NC, NPN NC	NPN NO, PNP NC, NPN NC	NPN NO, PNP NC, NPN NC

# WASHDOWN

FULL INOX	FULL INOX	FULL INOX
M18	M18	M30
20	20	20

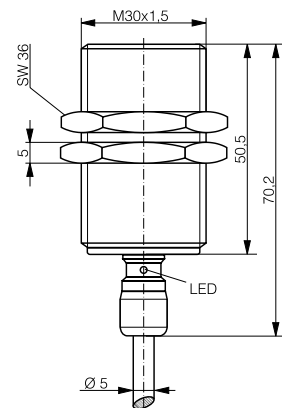
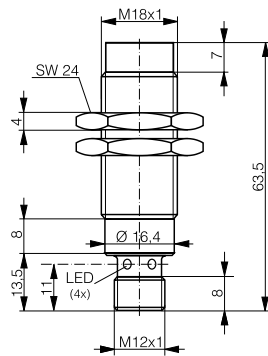
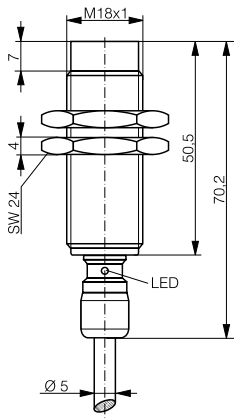

IO-Link	IO-Link	IO-Link
60 bar	60 bar	40 bar
Stainless steel V4A/AISI 316L	Stainless steel V4A/AISI 316L	Stainless steel V4A/AISI 316L
TPE-S cable	Connector S12	TPE-S cable
IP 68 / IP 69K	IP 68 / IP 69K	IP 68 / IP 69K
Non-embeddable	Non-embeddable	Embeddable
200 Hz	200 Hz	100 Hz
10 ... 30 VDC	10 ... 30 VDC	10 ... 30 VDC
-25 ... +85°C / -13 ... +185°F	-25 ... +85°C / -13 ... +185°F	-25 ... +85°C / -13 ... +185°F
≤ 200 mA	≤ 200 mA	≤ 200 mA
<b>DW-LD-713-M18</b>	<b>DW-LS-713-M18-002</b>	<b>DW-LD-703-M30</b>
NPN NO, PNP NC, NPN NC	NPN NO, PNP NC, NPN NC	NPN NO, PNP NC, NPN NC

Inductive

Photoelectric

Safety

RFID

Connectivity

Accessories

Glossary

Index