

WASHDOWN

FULL INOX	FULL INOX	FULL INOX
M18	M18	M30
20	20	20

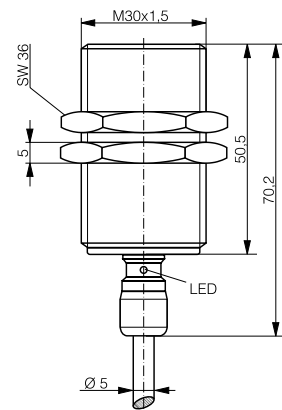
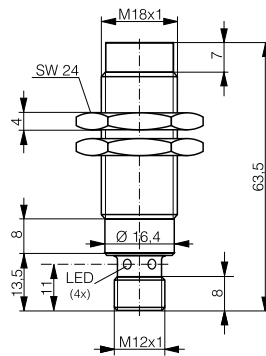
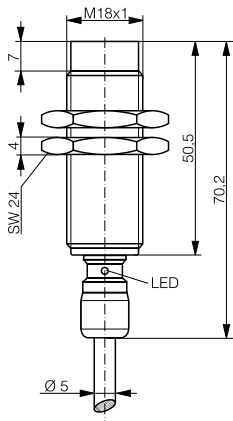

IO-Link	IO-Link	IO-Link
60 bar	60 bar	40 bar
Stainless steel V4A/AISI 316L	Stainless steel V4A/AISI 316L	Stainless steel V4A/AISI 316L
TPE-S cable	Connector S12	TPE-S cable
IP 68 / IP 69K	IP 68 / IP 69K	IP 68 / IP 69K
Non-embeddable	Non-embeddable	Embeddable
200 Hz	200 Hz	100 Hz
10 ... 30 VDC	10 ... 30 VDC	10 ... 30 VDC
-25 ... +85°C / -13 ... +185°F	-25 ... +85°C / -13 ... +185°F	-25 ... +85°C / -13 ... +185°F
≤ 200 mA	≤ 200 mA	≤ 200 mA
DW-LD-713-M18	DW-LS-713-M18-002	DW-LD-703-M30
NPN NO, PNP NC, NPN NC	NPN NO, PNP NC, NPN NC	NPN NO, PNP NC, NPN NC

Inductive

Photoelectric

Safety

RFID

Connectivity

Accessories

Glossary

Index

WASHDOWN

FAMILY

FULL INOX

FULL INOX

FULL INOX

HOUSING SIZE

M30

M30

M30

OPERATING DISTANCE MM

20

40

40

INDUCTIVE

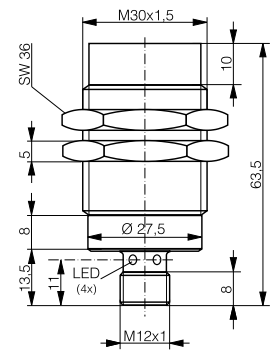
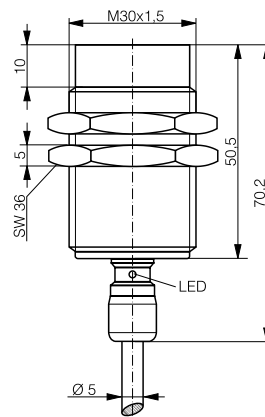
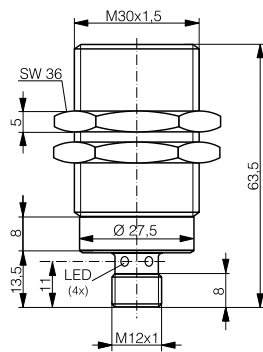

DATA

IO-Link

IO-Link

IO-Link

Operating pressure

40 bar

40 bar

40 bar

Housing material

Stainless steel V4A/AISI 316L

Stainless steel V4A/AISI 316L

Stainless steel V4A/AISI 316L

Connection

Connector S12

TPE-S cable

Connector S12

Degree of protection

IP 68 / IP 69K

IP 68 / IP 69K

IP 68 / IP 69K

Mounting

Embeddable

Non-embeddable

Non-embeddable

Max. switching frequency

100 Hz

90 Hz

90 Hz

Supply voltage range

10 ... 30 VDC

10 ... 30 VDC

10 ... 30 VDC

Ambient temperature range

-25 ... +85°C / -13 ... +185°F

-25 ... +85°C / -13 ... +185°F

-25 ... +85°C / -13 ... +185°F

Output current

≤ 200 mA

≤ 200 mA

≤ 200 mA

PNP NO

DW-LS-703-M30-002

DW-LD-713-M30

DW-LS-713-M30-002

Other types available

NPN NO, PNP NC, NPN NC

NPN NO, PNP NC, NPN NC

NPN NO, PNP NC, NPN NC